

Alistair LED Stairwell luminaire

Installation manual – Alistair (UCo3 sensor)

Caution: If the flexible wire or cord of this luminaire is damaged, it should substitute its technic service exclusively, or by a person with equivalents qualifications with the object of avoid any risk.

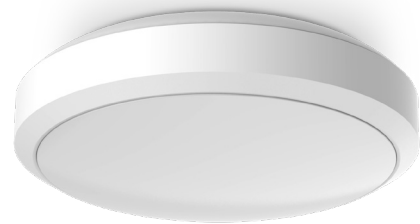

Parameters

MODEL NO.	RATED WATTAGE	RATED VOLTAGE	FREQUENCY	ENVIRONMENT TEMP	OUTPUT OF DRIVER	PF	DIMENSION
465313/465314	15 W	220-240V	50/60Hz	-20~40°C	350 mA	0.85	300 x 84 mm

Installation (for internal use only)

1: Make sure to turn off the main power.

2: Remove cover from fixture counter clock wise, then loosen the 3 screws, push the clip to lift light source PCB.

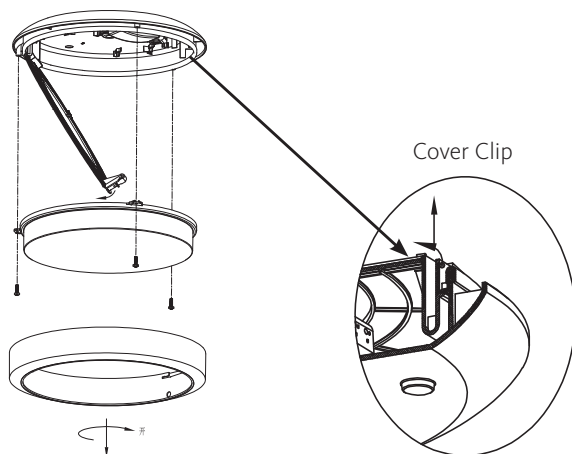

3: Pull the power supply wires out the fixture base, screw the fixture base on ceiling.



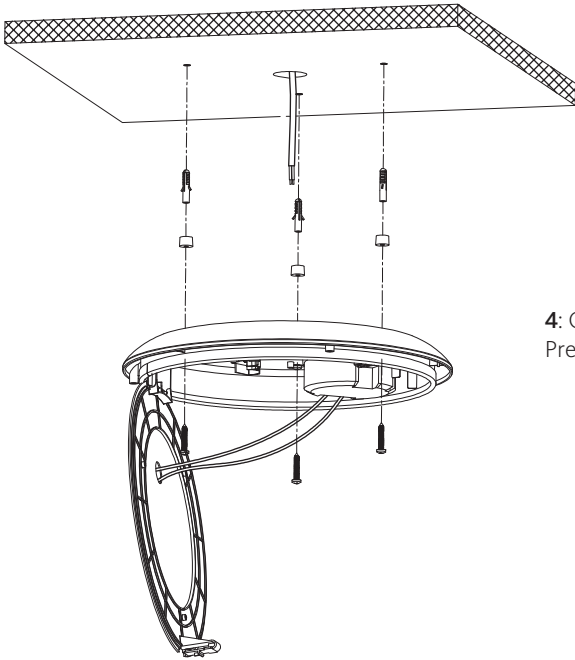

4: Connect the Power supply wires to the terminal block.
Press the cover clip back to original position.

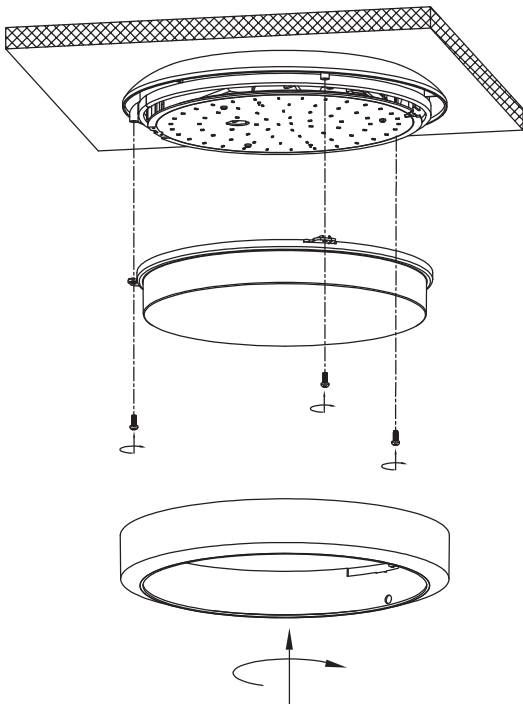
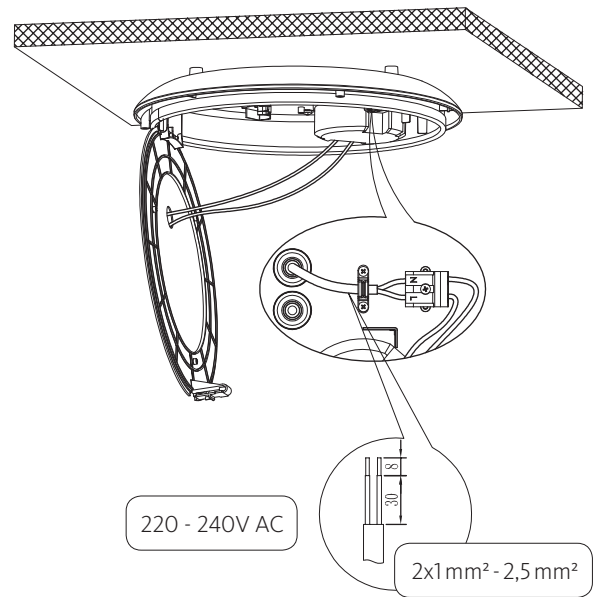

5: Screw the cover on ceiling light house.

6: Lock the trim on ceiling light cover by clockwise rotation.

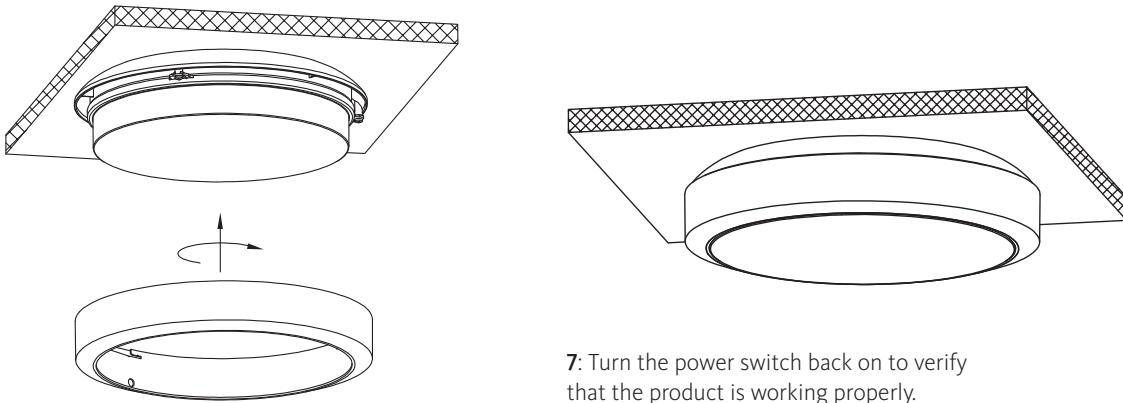

Note: Sensor Function.

1: The product can turn on the light based on movement. With this detector built in, light is automatically on when needed and dimmed to preset level before it is totally off.



With movement, the light is triggered on by the detector.



If there is no more movement, the light dims to stand-by level after hold-time.

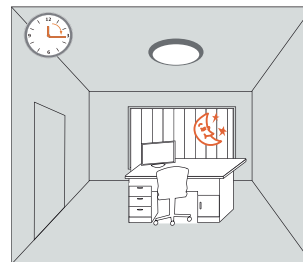

The light turns off automatically after stand-by time.

current	(W)	(lm)
500mA	24~25.5	2000~2100
450mA	22~23.5	1850~2000
350mA (default)	16	1420
300mA	14~15.5	1350~1400

8 hours straight on function: Sensor function is not needed in certain occasions. Rapidly turn off/on the power supply 3 cycles within 3 seconds, the LED light will be on for 8 straight hours.

Specifications:

Detection range: Max. (Ø x H): 12m x 6m.

Detection angle: 30°~ 150°.

Operating temperature: -20°C~+40°C.

Setting:

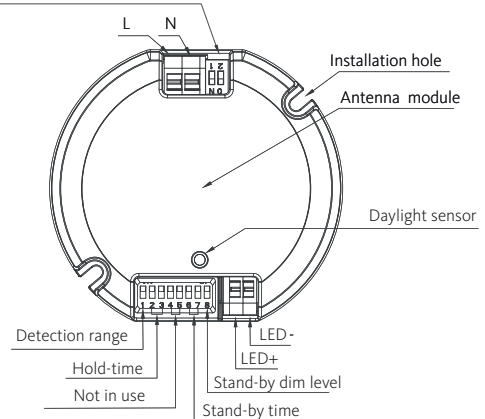

Detection range

Sensitivity can be adjusted by selecting the combination on the DIP switches for different applications.

I-100%
II - 50%



	1	
I	●	100%
II	○	50%

Hold-time

Hold-time refers to the time period that the light remains 100% on if no more movement is detected.

I-5 s
II-90 s
III-3 min
IV-10 min



	2	3	
I	●	●	5 sek
II	●	○	90 sek
III	○	●	3 min
IV	○	○	10 min

Daylight sensor

Dierent daylight threshold can be preset on DIP switches. Light will always turn on upon movement if daylight sensor is disabled.

I-Disable
II-50Lux
III-10Lux
IV-2Lux



	4	5	
I	●	●	Disable
II	●	○	50Lux
III	○	●	10Lux
IV	○	○	Lux

Stand-by time

The time period that the light remains at a low level before it is completely turned off.

I-0 s
II-10 s
III-10 min
IV-+∞



	6	7	
I	●	●	0 sek
II	●	○	10 sek
III	○	●	10 min
IV	○	○	+∞

Stand-by dim level

Light can be dimmed to different levels after hold-time.

I-10%
II-30%



	8	
I	●	10%
II	○	30%

Warning!

Disconnect the Unit before replacing the Lamp. Do not use with dimmers. Use double insulation cables from the fixing wiring to connect with the terminal block in luminaire. Make sure wire are connected to terminal by instruction item 4. Do not change LED current selection.If the external flexible cable or cord of this luminaire is damaged, it shall be exclusively replaced by the manufacturer or his service agent or a similar qualified person in order to avoid a hazard.

Correct Disposal of this product:

This marking indicates that this product should not be disposed with other household wastes throughout the EU. To prevent possible harm to the enviroment or human health from uncontrolled waste disposal, recycle it responsibly to promote the sustainable reuse of material resources. To return your used device, please use the return and collection systems or contact the retailer where the product was purchased. They can take this product for enviromental safe recycling.



Dimensions

