

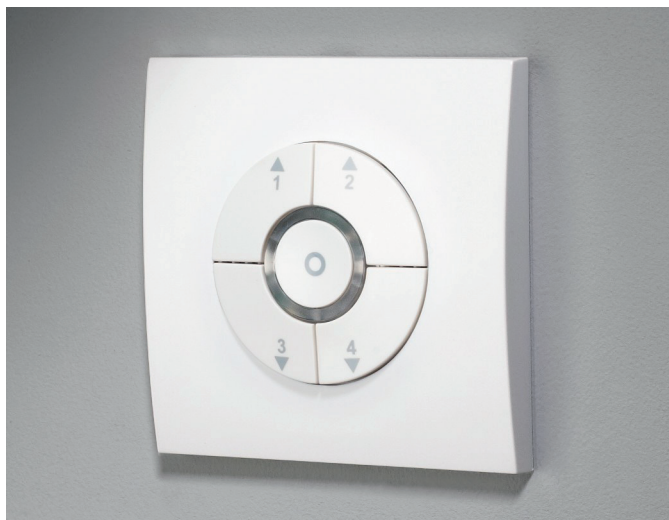

DA-SG -4PM -W

DALI / DSI dimmer switch

Overview



The DA -SG -4PM -W is a single channel controller for DALI or DSI devices. The product has the following controls.

Scene buttons

Four buttons that offer 4 lighting levels. The default levels are:

- 1 - 100% brightness
- 2 - 75% brightness
- 3 - 50% brightness
- 4 - 25% brightness

These levels can be easily changed, see below.

Raise and lower function

Use either buttons 1 and 2 to raise the light level.

Use either buttons 3 and 4 to lower the light level.

Off button

Toggle between lights off and last selected Scene.

Note: the data sent from the DALI output is in broadcast mode and is not suitable for addressed systems.

Using the dimmer switch

Turning Lights On and Off

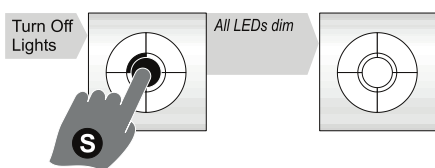
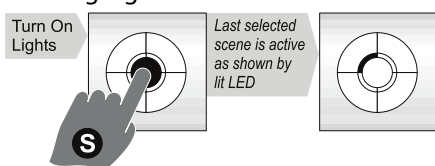

Programming Scenes

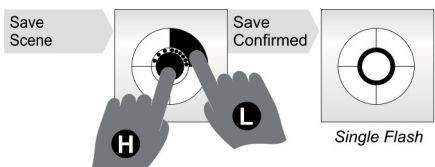
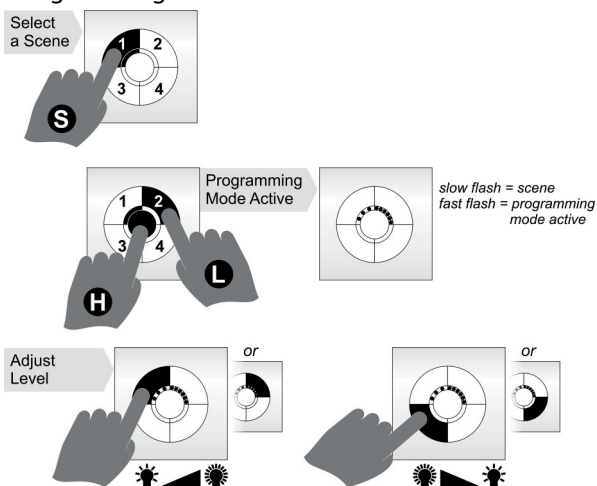

Selecting a Scene level

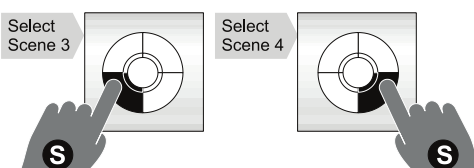
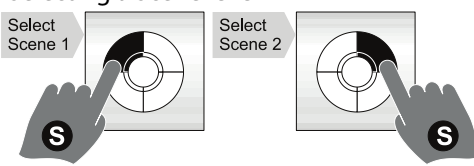

Adjusting Current Light Levels - Raise

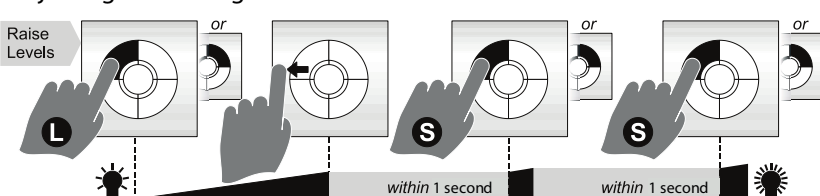

Adjusting Current Light Levels - Lower

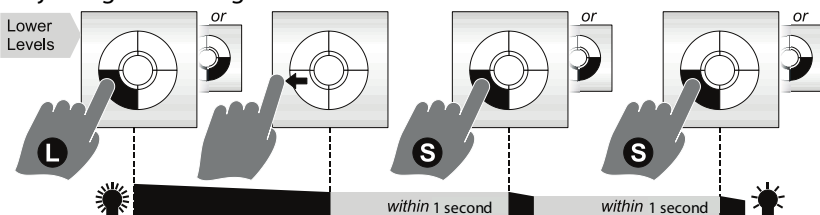

Changing from DALI to DSI

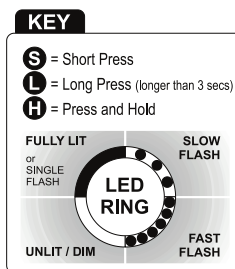
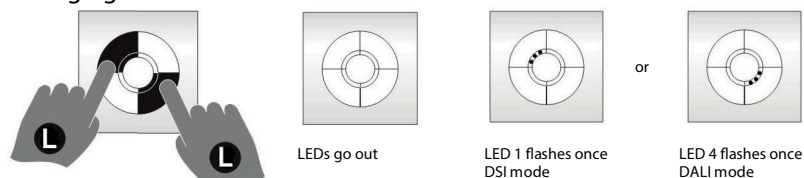

Installation

Remove front cover by using a flathead screwdriver or similar to gently prise off the cover.

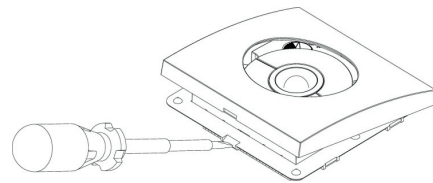

Back box Compatibility

The DA -SG -4PM -W is designed to fit both UK and EU style backboxes.

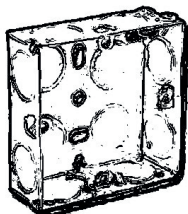

BS4662 square back box

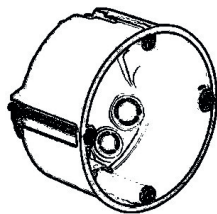

DIN standard round back box

Mounting

Use the extender if there is less than 25mm free space.
Note: put the wires through the extender before connecting.

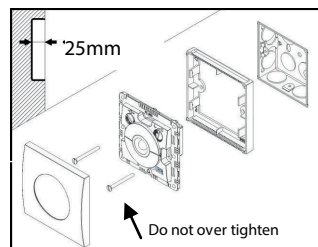

Wiring

Connect to DALI / DSI device(s)

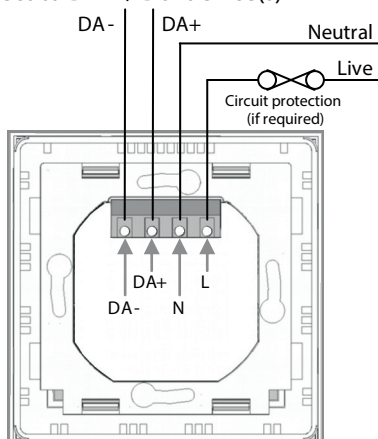

Dimensions

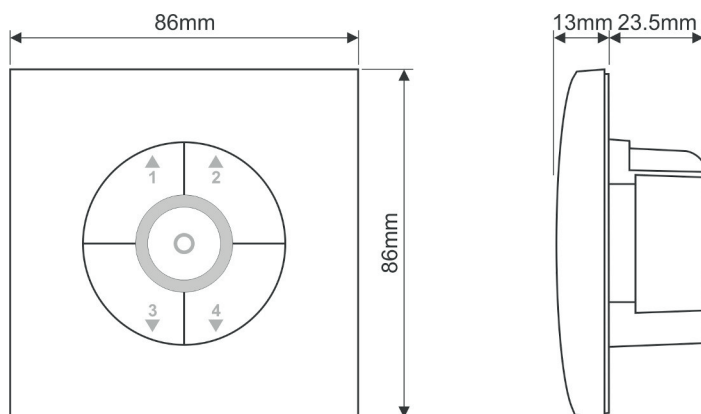

Technical data

Supply Voltage	230VAC +/- 10%
Frequency	50Hz
Power consumption	On 528mW, Off 523mW
Load	20 DALI or DSI ballasts
Weight	0.1kg
Fixing method	Surface fixing : 35mm deep plastic surface mount moulded box. Flush fixing: 25mm steel backbox

Temperature	or 25mm deep cavity backbox.
Humidity	-10°C to 35°C
Material (casing)	5 to 95% non -condensing Flame retardant ABS Type Class 2
Compliance	EMC -2004/108/EC LVD -2006/95/EC



Part numbers

	Part number	Description
Dimmer switch	DA-SG -4PM -W	DALI / DSI dimmer switch - white
Accessories	GIFP -ST	GI fascia Silver
	GIFP -BZ	GI fascia Bronze
	UHS7	IR user handset

IMPORTANT NOTICE!

This device should be installed by a qualified electrician in accordance with the latest edition of the IEE Wiring Regulations and any applicable Building Regulations.



FM 45789

EMS 534520



Tfn kundtjänst +46 20 32 30 30
www.auralight.se