

Melba

Installation manual

- 1: Switch off before installation.
- 2: Switch on only after complete installation and examination of the circuit.
- 3: Professional electrician for installation and maintenance only.

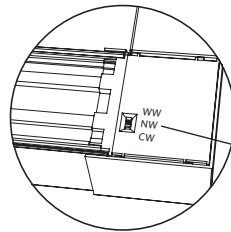
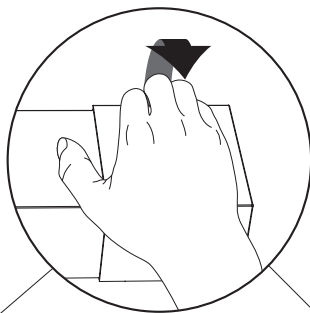
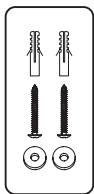
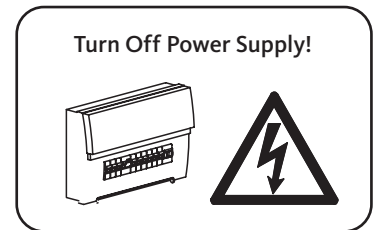

Select preferred colour temperature for product in CCT change function only. N.B. The CCT switch is located on the backside of the luminaire.

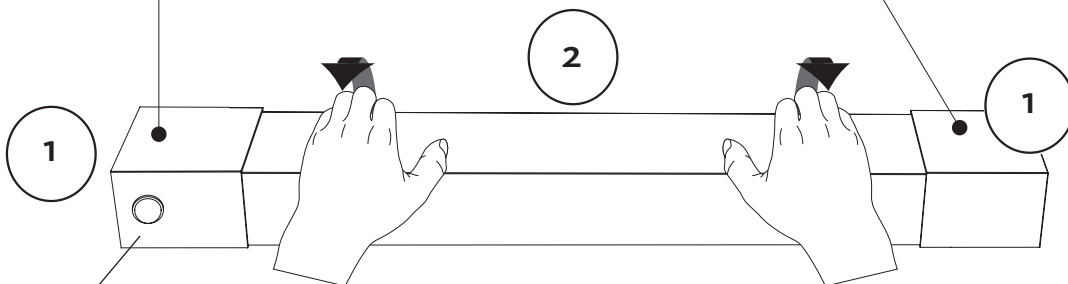
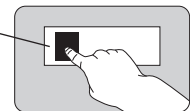

Socket for PIR presence sensor.

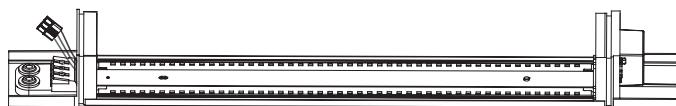
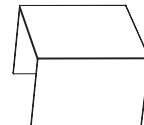
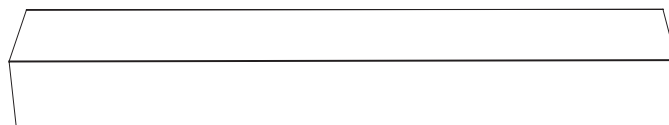
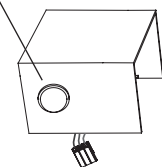

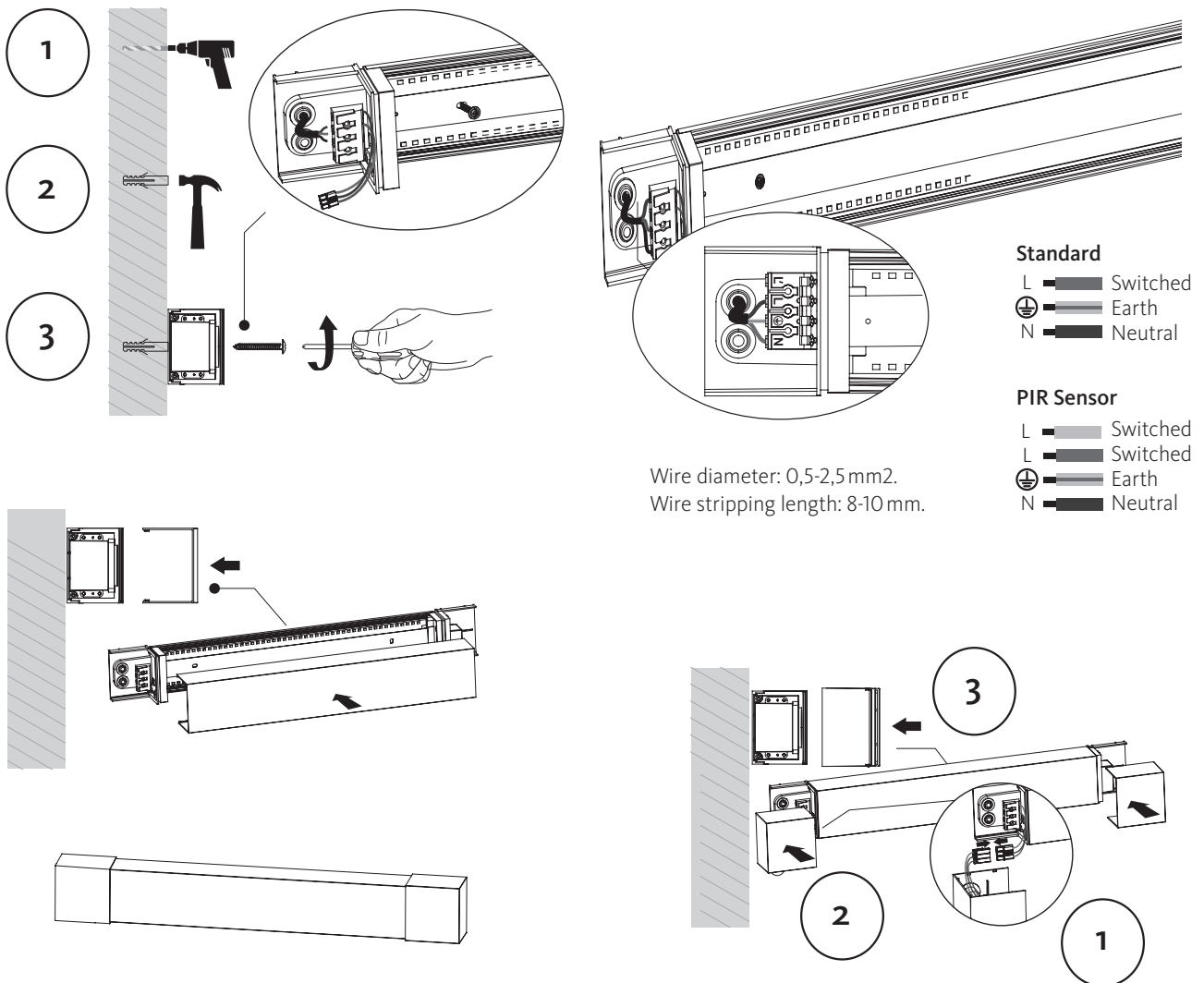

Safety Instructions

- 1: Read all instructions.
- 2: Licensed electrician for installation only.
- 3: Always ensure the power is OFF and the fitting has cooled down before performing any maintenance, cleaning, changing the globe or adjustment to the fitting.

Basic safety precautions should always be followed when installing, including the following

- 4: Do not install any luminaire near the heat source.
- 5: Do not exceed the nominal supply voltage or amperage ratings.
- 6: To avoid injury or damage to the fitting, please ensure that power leads and screws are secure before connecting the power.