

Eris

Installation manual

1: Take out the lamp and accessory.

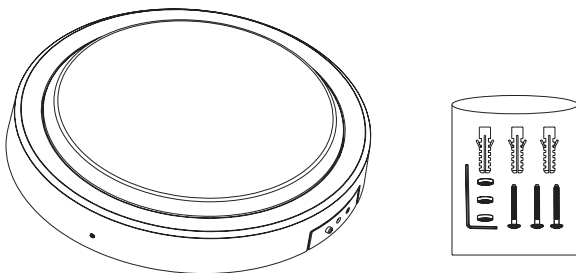

2: Separate frame and lamp shade.

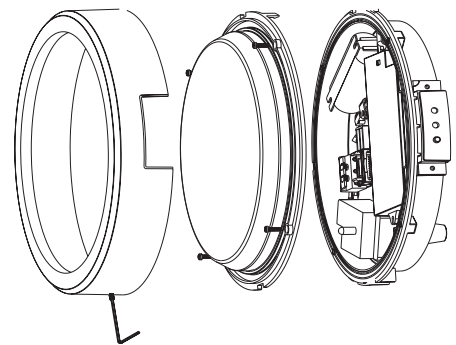

3: Fix the back housing on the wall or ceiling by screws.

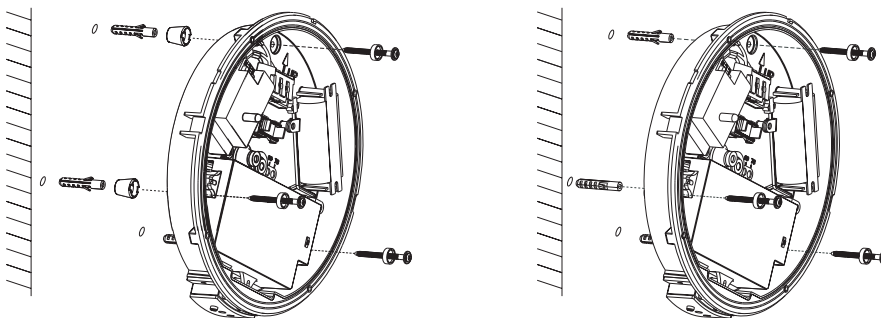

4: **a.** Connect the plugs between the battery and driver if with emergency function. **b.** Choose the power with DIP switch. **c.** Connect the AC wires to the block.

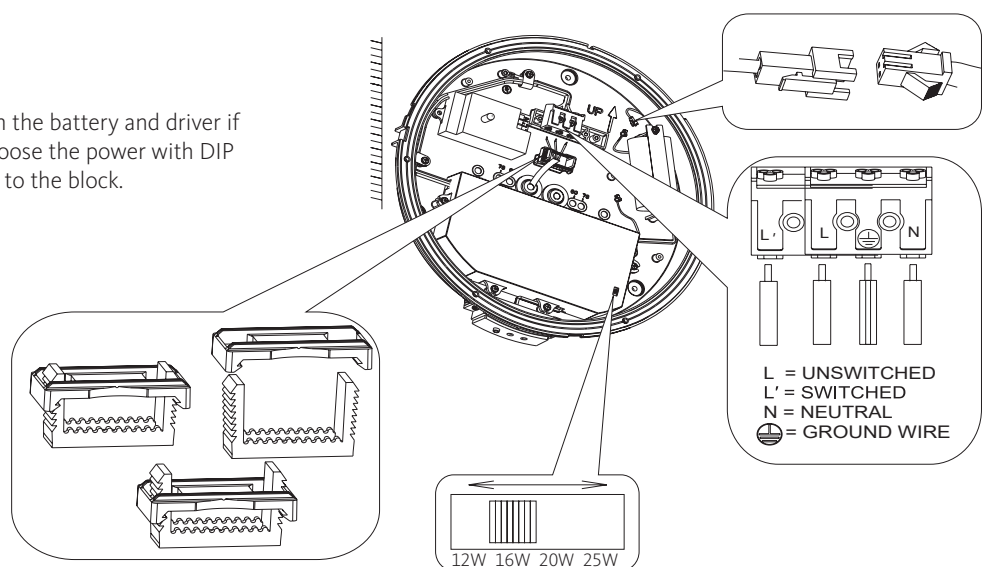

5: Connect the DC plugs, put back the cover to the back plate and fix it by the screws.

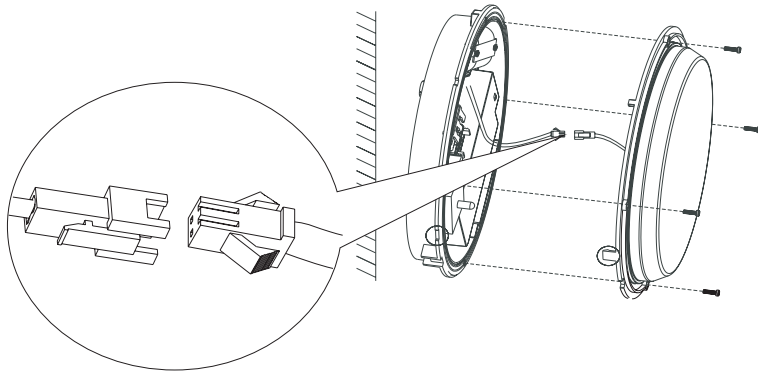

6: Buckle the frame back and fix it by proper tools.

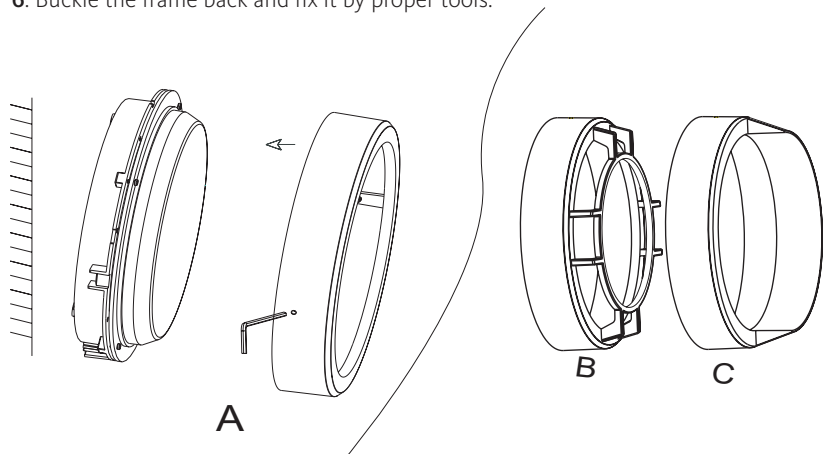

7: Installation finished, turn on the switch.

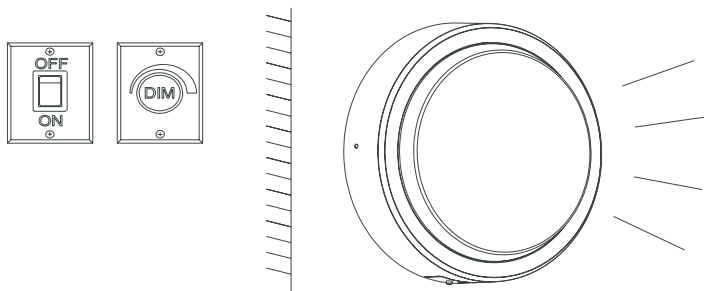

Warning!

- 1: Switch off before installation.
- 2: Switch on only after complete installation and examination of the circuit.
- 3: Professional electrician for installation and maintenance only.

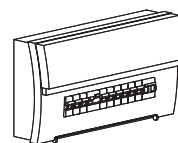

Turn off power supply!