

Sevede CE

Installation manual

1: Luminaire ceiling brackets.

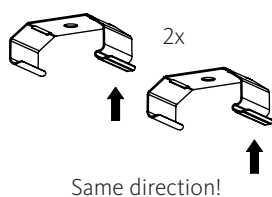

| VERSION | C:C MIN. (mm) | C:C MAX. (mm) |
|----------------|------------------|------------------|
| Sevede CE 600 | 300 | 540 |
| Sevede CE 1200 | 600 | 1100 |

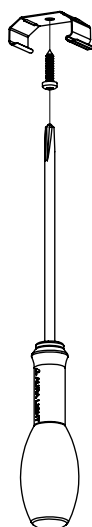

2: Mount luminaire ceiling brackets (2x). Screws not provided.

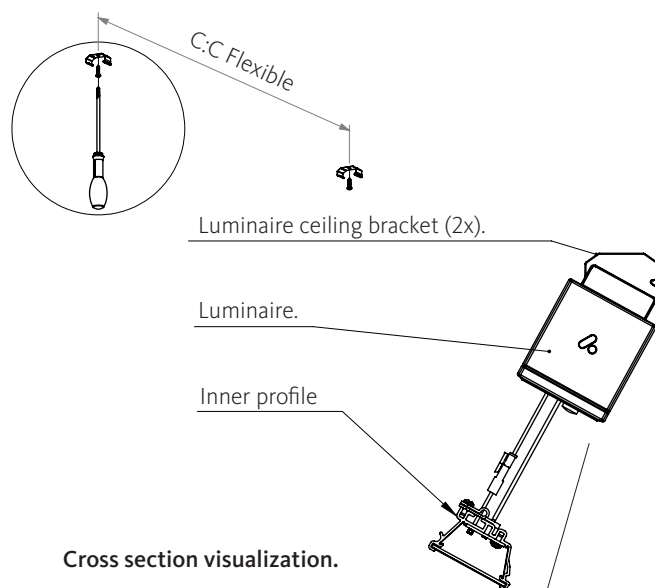

3: Mount luminaire.

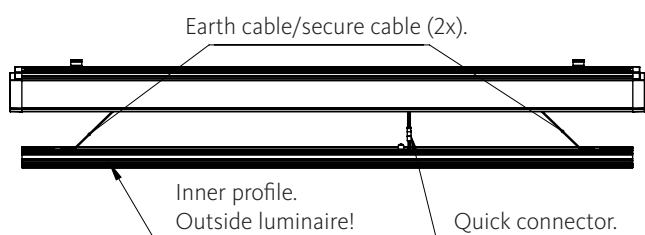

Cross section visualization.

Hang luminaire.
Hinge-function.

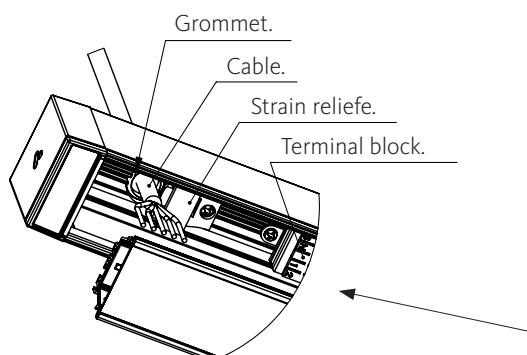
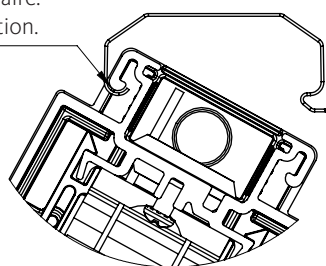

4: Prepare cable.

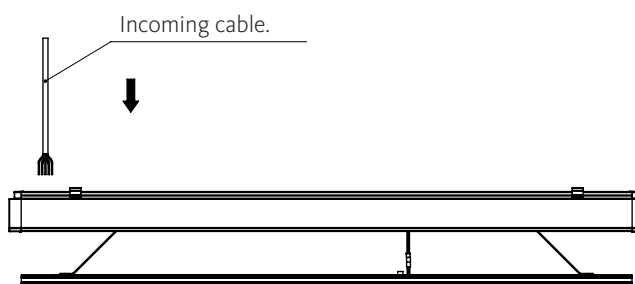

5: Secure luminaire.

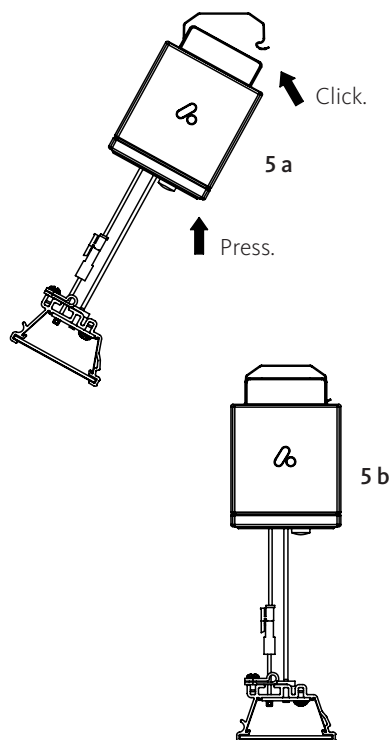

6: Electrical installation.

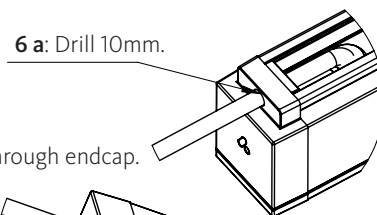
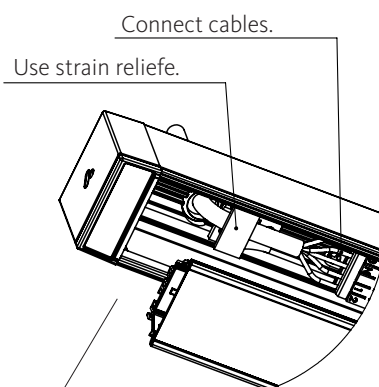

6 b: Through endcap.

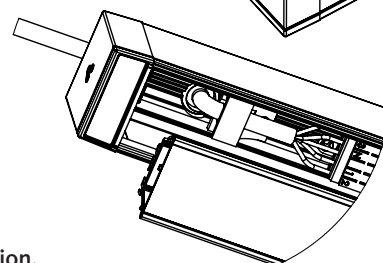

7: Mount inner profile.

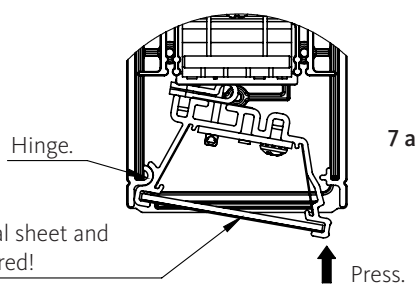

Secure optical sheet and keep it centered!

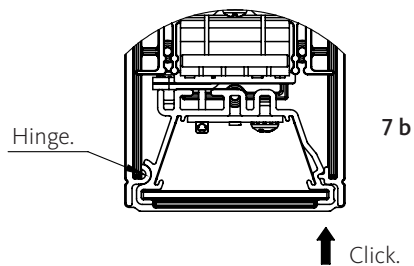

Cross section visualization.

Keep inside cables away when mounting inner profile!

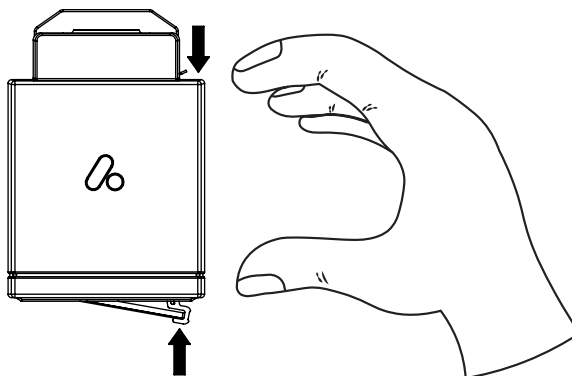

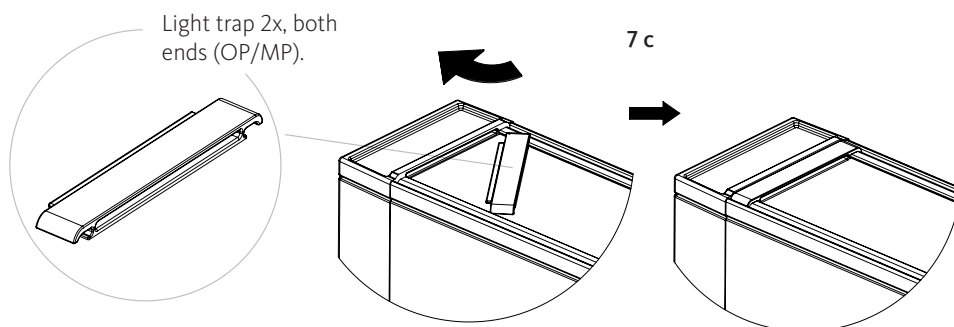

8: Removal of inner profile.
Only for maintenance.

Orientation

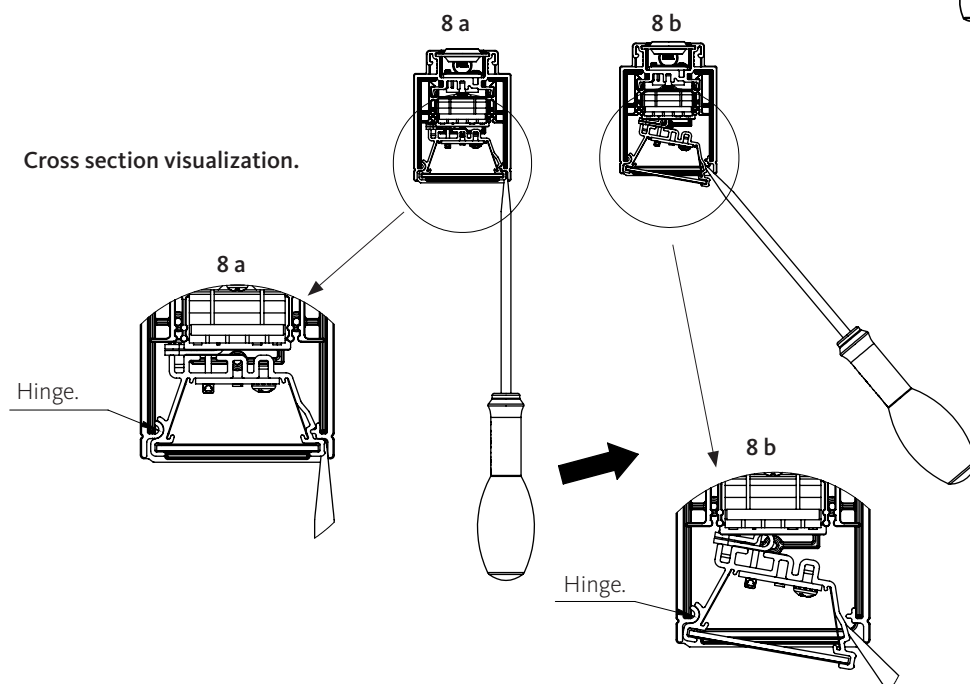
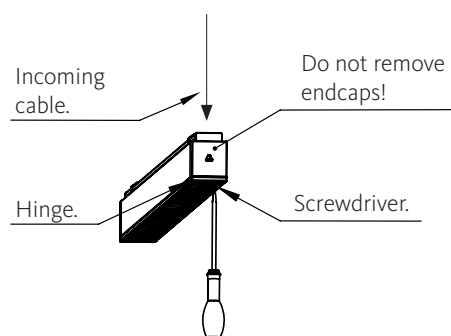

8 c

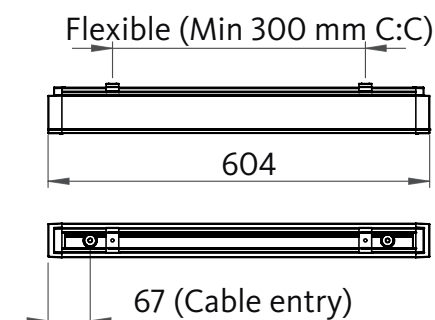
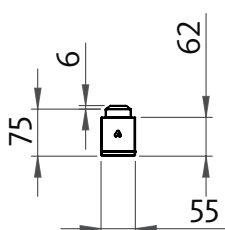
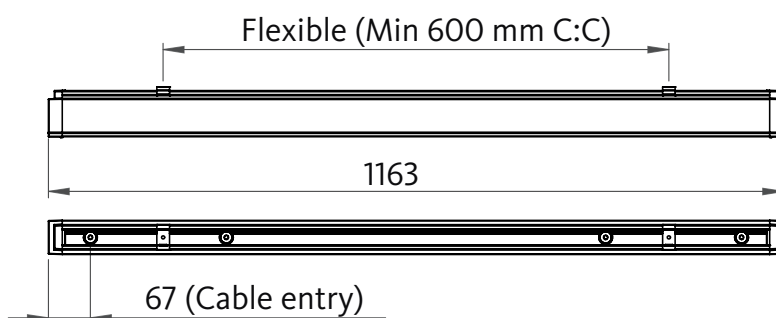
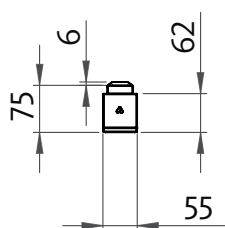
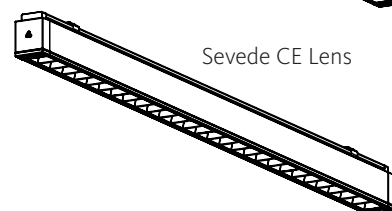
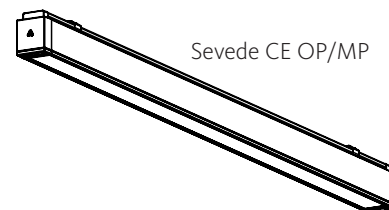
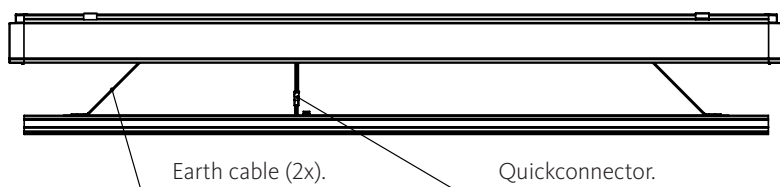

Note: The light source contained in this luminaire shall only be replaced by the manufacturer or his service agent or a similar qualified person.

Basic insulation between supply- and control-terminals (DALI).

If the external flexible cable or cord of this luminaire is damaged, it shall be exclusively replaced by the manufacturer or his service agent or a similar qualified person in order to avoid a hazard.



Installation movie