

Berzelia CL 2025

Installation manual

TECHNICAL FEATURES	
Voltage	220-240V~
Frequence	50/60Hz
Insulation Class	Class I/Class II
Weight (kg)	10,9
t _a	50 °C
Power Factor	>0,95
Projection Area	0,25m ²
Glass	Tempered Glass

SERIES/MODEL	LED	P MAX (W)	SUPPLY CURRENT (A)	CLASS I	CLASS II
Berzelia CL 2025	64	68	0,31	X	X
		102	0,46	X	X
		150	0,68	X	X
		175	0,80	X	X
		200	0,91	X	X
		320	1,45	X	X
		300	1,36	X	-

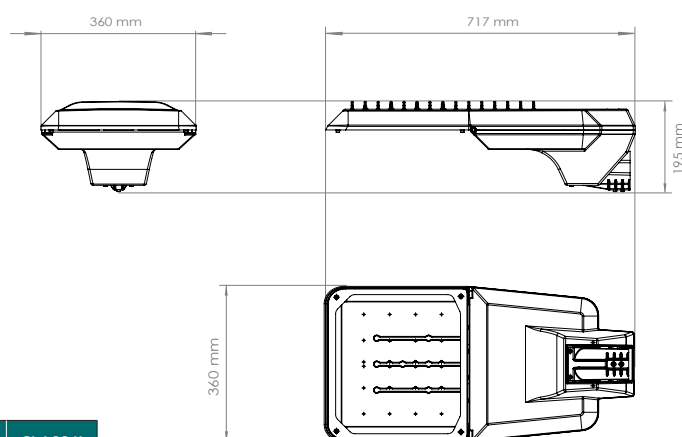

- 1: Suitable for use outdoor.
- 2: If the external flexible cable or cord of this luminaire is damaged, it will be exclusively replaced by the manufacturer or his service agent avoid a hazard.
- 3: Terminal block not included. Installation must be performed by a qualified person.
- 4: The light source contained in this luminaire shall only be replaced by the manufacturer or his service agent or a similar qualified person.
- 5: Recommended pole height is between 4-8 meters due to the wattages and only to be installed outside arms reach.

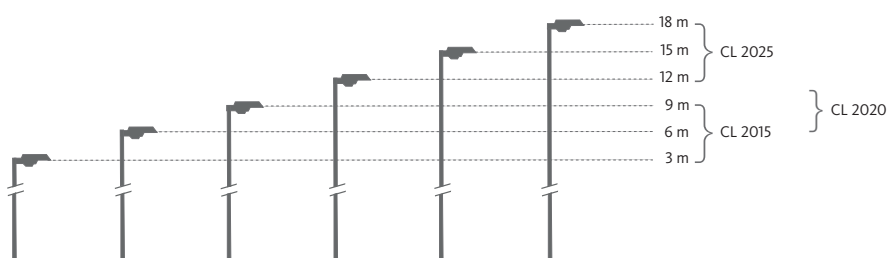

Note: Only original spare parts should be used in maintenance.

6: By the help of adjustable mounting module luminaire could be fixed both from side and postup entries with 16 different angles.

7: 10 nm force should be applied to the bolt of the mounting module for closing.
For pole mounting; two stainless steel allen key (4 size) or bolt keys (13 size) should be used.

8: Luminaire should be fixed to the pole or console with size 4 key.

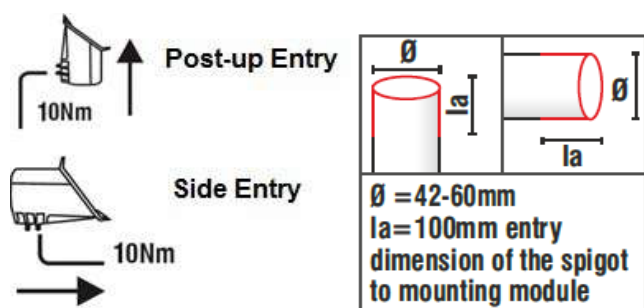

9: Luminaire has easy connect system for the electricity connection.

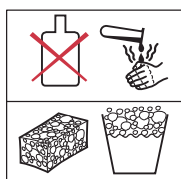
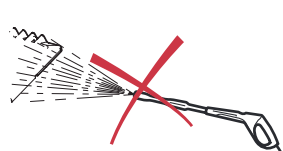

CLASS I		
Brown	Blue	Green/Yellow
Line	Neutral	Earth

CLASS II	
Brown	Blue
Line	Neutral

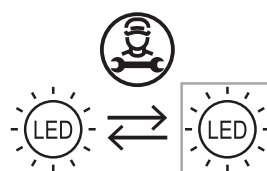

Replaceable LED light source by a professional or manufacturer.

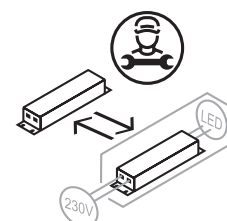

Replaceable control gear by a professional.

